

ROAD BLOCKERS

CITY-LIGHT SPEEDBUMPS



RELIABLE, PRACTICAL AND COST-EFFECTIVE SOLUTION TO
PROVIDE 100% SECURITY OF YOUR TERRITORY

TISO City-light Speedbump is a unique simple solution for vehicle access control establishment and adjustment. Its biggest advantage relates to installation type options, including both surface installation and shallow mounting and frequent use in high intensity mode. Dealing with surface installation, in raised position TiSO serves like a regular road blocker. When closed, performs the function of a speed hump. Built-in hydraulic unit advances this type of equipment for projects which require large distances (up to 100m) between blocking part and control unit. Wide arrangement of options enables it to be and widely applicable and versatile security solution.

Installation areas

- Governmental Institutions
- Military Bases
- Nuclear Power Plants
- Production sites (Industrial Plants)
- Commercial areas
- Financial institutions
- Airport Premises
- Business (Office) Center
- Hotels
- Sport Complexes
- Recreation areas
- Urban areas
- Education Institutions



www.tiso.global
+380 (44) 291-21-11
e-mail: sales@tiso.global



Shallow mounted installation

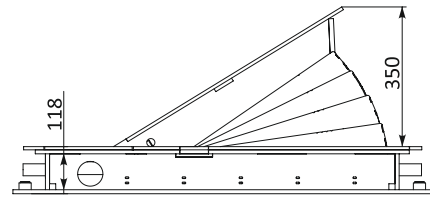
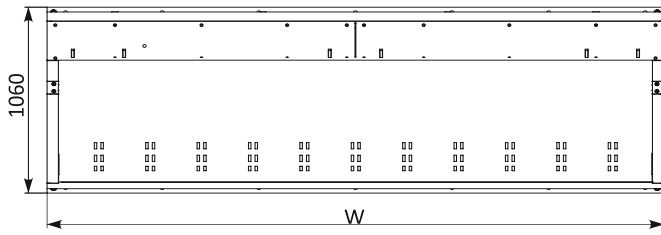

Above the ground installation

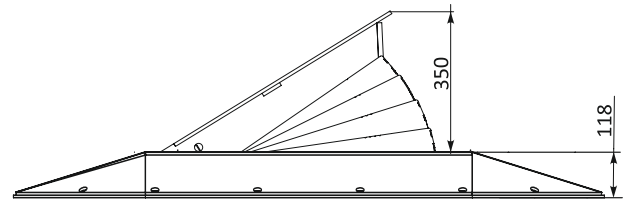
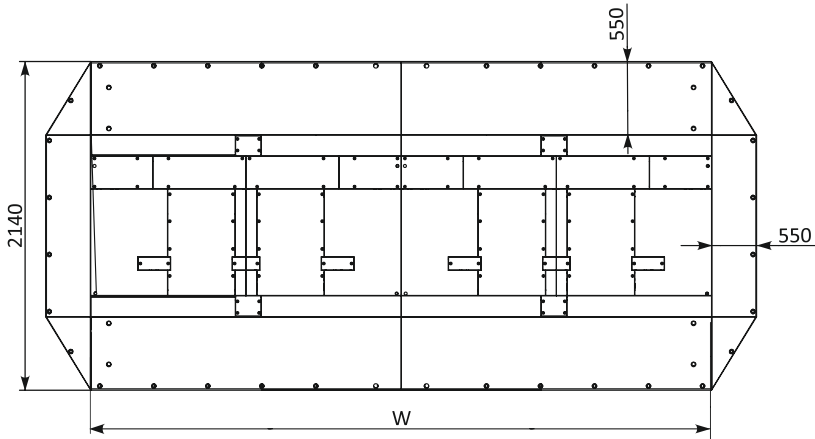

TECHNICAL SPECS:

Model	RB357-02	RB357-03	RB357-04
Installation type	Shallow mounted / Above the ground installation		
Drive	Hydraulic		
Width, mm	2000	3000	4000
Height, mm	350		
Load per axle, t	15		
Rising time, sec	5,0	5,2	5,5
Lowering time, sec	4,0	4,1	4,2
Operating temperature*, °C	-40/+60		
Power supply	1 phase 230 V, 50/60 Hz		
Protection level	IP 67 for Road blocker IP 55 for control box		
Materials	- Structural steel C22 (powder coated) - Structural rubber		
-moving part			
-ramps			

*for temperatures lower than -10 °C use the heating device
for temperatures higher than +40 °C use the cooler device



www.tiso.global
+380 (44) 291-21-11
e-mail: sales@tiso.global

